

# Dualit®

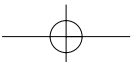

GUARANTEE AND  
INSTRUCTIONS FOR  
THE DUALIT BUN AND  
SANDWICH TOASTERS

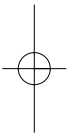
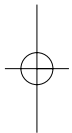

## CONTENTS

<b>INTRODUCTION.....</b>	<b>4</b>
<b>SAFETY PRECAUTIONS.....</b>	<b>4 / 5</b>
<b>BOX CONTENTS.....</b>	<b>5</b>
<b>BEFORE FIRST USE.....</b>	<b>5</b>
<b>PARTS &amp; CONTROLS.....</b>	<b>6</b>
<b>THE BUN TOASTER.....</b>	<b>7 / 8</b>
USING THE BUN TOASTER	
BUN TOASTING TIPS	
<b>THE SANDWICH TOASTER.....</b>	<b>8 / 9</b>
USING THE SANDWICH TOASTER	
SANDWICH TOASTING TIPS	
<b>SERVICING.....</b>	<b>9 - 11</b>
CLEANING & MAINTENANCE	
GUARANTEE	
REPLACING ELEMENTS	

# BUN & SANDWICH TOASTER

## INTRODUCTION

The perfect way to make toasted sandwiches or buns. The Dualit toaster range is compact, convenient and specially designed for the job in hand. Before using your Dualit toaster for the first time please read these instructions carefully so that you obtain the best possible results.

## IMPORTANT SAFEGUARDS

**PLEASE READ ALL THE INSTRUCTIONS BEFORE USING THE TOASTER**

**KEEP ALL INSTRUCTIONS FOR FUTURE REFERENCE**

## SAFETY PRECAUTIONS

- **WARNING:** This appliance must be earthed
- We recommend that the toaster is plugged into a socket that has no other appliance connected to it. Failure to do this may cause an overload, trip a circuit breaker or blow a fuse. Preferably the socket outlet should be protected by a Residual Current Device (RCD).
- Before plugging in, check that the voltage on the rating label is the same as the mains supply.
- To protect against electric shock, do not immerse any part of this product in water or other liquid.
- Unplug from outlet when not in use and before cleaning. Allow to cool before putting on or taking off parts.
- Do not operate the appliance with a damaged cord or plug. Do not allow cable to touch hot surfaces, or to hang over edge of a table or counter top.
- When in use a fire may occur if the toaster is covered or touching flammable material.  
Bread may burn. Therefore toasters must not be used near or below curtains or other combustible materials.
- Do not attempt to dislodge bread items when the toaster is plugged in.
- When toasting do not leave appliance unattended.
- This appliance is not intended for use by young children or infirm persons without supervision.

## SAFETY PRECAUTIONS

- Young children should be supervised to ensure that they do not play with this appliance.
- Do not use outdoors.
- Do not store in an appliance garage.
- With continuous use parts of the toaster may get hot.
- **NOTE:** Any plug cut from power supply cord should be disposed of immediately. Inserting any cut off Plug into a 13A socket-outlet is hazardous.
- Never use the plug without the fuse cover fitted. Ensure replacement fuse is the same current value as original.
- Replacement fuses are available from Dualit and should be ASTA approved to BS 1362.

## SAVE THESE INSTRUCTIONS

## BOX CONTENTS

Unpack the shipping container.

Remove all visible packaging material.

Before using the toaster, check the following items are in the box:

- The toaster
- Crumb tray
- Recipe booklet (Sandwich toaster only)
- Sandwich cages. 2 with 2 slot and 4 with 4 slot (sandwich toaster only)
- This manual - Keep safe for future reference.

If any damage is discovered or any of the parts are missing contact the place of purchase or Dualit customer care line on 01293 652 500 for further information.

## BEFORE FIRST USE

Read this manual fully to get the best out of your toaster.

### CONDITIONING ELEMENTS

- Your Dualit toaster has patented ProHeat elements.
- To condition the elements before toasting for the first time, preheat an empty toaster with all slots turned on for three minutes. Slight smoking may occur, this is perfectly safe.
- When the toaster is used there may be a slight popping crinkling sound, this is due to heat expansion of the element surface and is NOT a fault.

### ADJUSTABLE FOOT

- Your toaster is fitted with one adjustable rear foot which may be hand turned, to raise or lower the toaster, to compensate for uneven work surfaces.

## PARTS AND DESCRIPTION

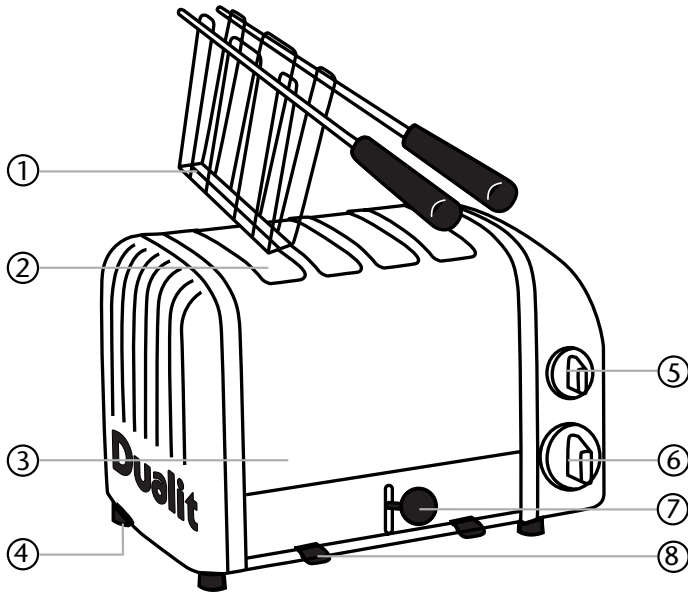

1. **Sandwich cages** (only with sandwich toaster).
2. **28mm wide slots** - Fit sandwiches or large buns in these super wide slots.
3. **Stainless steel cover** - easy clean durable cover.
4. **Adjustable foot** - can be raised or lowered to compensate for uneven surfaces.
5. **Slot selector switch** - select which slots will heat up.
6. **Mechanical timer** - on/off control with countdown timer.
7. **Ejector knob** - Manually eject buns from the slots (only on Bun toaster).
8. **Crumb tray** - Removable easy clean tray catches drips of crumbs.

## THE BUN TOASTER

### USING THE BUN TOASTER

- Select the number of slots to be activated using the slot selector switch. Lift the round black Ejector Knob to the up position. Starting from left to right, insert buns into all slots brought into operation by the selector switch.
- Turn the Time Switch Knob clockwise to the required number on the dial.
  - 1.5 = Lightly browned toast
  - 2.0 = Medium toast
  - 2.5 = Well done toast.
- If using brown bread or other items, cooking times may vary.
- The Dualit toaster can accommodate large buns upto 115mm diameter and 28mm thick. However, if the bun protrudes out of the top of the toaster, you can turn the bun upside down midway through the toasting process.
- When the toaster is cold and being used for the first time set the timer Knob to 2.5 because the metal body will absorb some heat.
- After the toaster has warmed up, reduce the toasting time to give consistent results.
- As soon as the Time Switch is rotated the automatic timing will start and the red neon light will illuminate.
- The timer will click off from 0.5 to 0 position with a clicking sound, the neon light & elements will switch off automatically.
- The timer can be rotated off at any time during the toasting process by manually rotating the timer knob to the 0 position.
- The toasted item will not pop up, but will keep warm inside the toaster.
- Press down on the round Ejector Knob and the bun will push up ready for serving.
- To reheat recently toasted buns set timer to approx 1 setting.
- To toast frozen buns increase toasting time by 1 setting

**CAUTION:** Heating up a slot that has not been loaded with bread may damage the elements and cause uneven toasting. Do not use the toaster if the crumb tray or base plate are missing or are incorrectly fitted.

## THE BUN TOASTER

### BUN TOASTING TIPS

- We recommend the use of 1 or 2 days old, medium or thick sliced buns. Slices should be cleanly cut and not ragged edged.
- Do not force in too thick or too long items as when these are toasted, difficulty may be experienced in ejecting them. Never insert broken buns.
- Insert buns in all switched on toasting slots. If some heated slots are empty the remaining slots will toast unevenly. The empty slots will cause the elements to over heat and burn prematurely.
- Never use the toaster as a hotplate by covering the top of the toaster.
- Dualit toasters are fitted with high quality, heavy duty elements. However, the life of an element cannot be guaranteed as this depends entirely upon the treatment received by the user.

## THE SANDWICH TOASTER

### USING THE SANDWICH TOASTER

- The sandwich toasters are supplied with Sandwich cages. Additional cages can be purchased as an accessory.
- Using medium sliced bread, lightly butter one side of each slice and place filling between un-buttered sides. Use the sandwich cage recipe book for various ideas. Pre-sliced or grated cheeses work best.
- Place sandwich into a cage and insert into one of the slots.
- The two slot sandwich toaster uses two timer dials. (The top one switches on the left hand slot and the bottom one switch the right hand slot).
- The four slot has a 3 position rotary switch to select 1,2 or 4 slots and a single timer.
- Set timer dial for each loaded slot to between no. 2.5 and no. 3.5 according to the darkness required. After the toaster has warmed up, reduce time by half a number (Usually after 2 or 3 cycles).
- The timer dial turns off automatically after the selected time cycle has finished or can be reset manually by turning the timer knob back to the off position.
- The sandwiches will keep warm inside the toaster until removed for serving.
- See the included recipe booklet for lots of inspirational ideas.



## SANDWICH TOASTER

### SANDWICH TOASTING TIPS

- Always **lightly** butter the OUTER sides of the sandwich as this will make the filling hotter.
- We recommend the use of 1 or 2 day old bread. Slices should be cleanly cut & not ragged edged.
- Very thinly sliced bread may produce uneven toasting.
- Do not force in thick slices of bread as you may experience difficulty in ejecting them. Never insert broken pieces of bread.
- If heated slots are left empty the adjacent slots will toast unevenly.

**CAUTION:** Heating up slots that have not been loaded with bread may damage the elements and will cause uneven toasting. Do not use the toaster if the crumb tray or base plate are missing or are incorrectly fitted and never cover the top of the toaster or use as a hot plate. Always

## SERVICING

### CLEANING AND MAINTENANCE

unplug the toaster when not in use.

Cleaning and maintaining your toaster on a regular basis will keep it shining and prolong the life of your machine.

- **IMPORTANT:** Always unplug the toaster and allow to cool down before performing any cleaning.
- Remove crumb tray & clean daily.
- Crumbs should be carefully brushed off the elements (using only a soft brush), the toaster turned upside down and shaken out.
- Never insert a fork or other sharp instrument to remove torn pieces of bread as the heating elements may be damaged.
- Use a microfiber or damp cloth to wipe off the outside surfaces of the toaster. Do not use any cleaner on the end castings, wipe

and dry.

- A stainless steel polish can be used to restore shine but this must not be an aggressive cleaner or contain ammonia and should only be used on the stainless steel cover.
- This appliance must not be immersed in water or cleaned with a water jet.
- Sandwich cages are dishwasher safe or can be washed in warm soapy water. Do not use abrasive cleaners.
- Empty the crumb tray on a daily basis, do not allow crumbs to build up.

## SERVICING

### GUARANTEE

In the unlikely event of the toaster failing within 2 year or your heating elements within 5 years from date of purchase, Dualit will repair or replace it free of charge, provided:

- you have not misused, neglected or damaged the part;
- the appliance has not been modified;
- a receipt is supplied showing where and when the toaster was purchased.

This guarantee does not affect the purchaser's statutory rights.

Further advice on using your Dualit toaster, or other products in the Dualit range, is available from:

Dualit customer care line on +44(0)1293 652 500

Alternatively e-mail Dualit on [info@dualit.com](mailto:info@dualit.com) or [www.dualit.com](http://www.dualit.com)

### REPLACING PROHEAT ELEMENTS

Spares for your Dualit toasters are available by mail order, call us on 01293 652 500 for more details.

- Servicing must only be carried out by Dualit authorised service agent or a competent electrician.
- For your own protection only use original Dualit spares in your toaster.
- When replacing Pro Heat elements, only use genuine Dualit elements (stamped "DUALIT") the safety and the performance of the toaster cannot be guaranteed if inferior elements are used. Fitting of non Dualit parts will also invalidate the guarantee.
- A. Disconnect toaster from mains.
- B. Remove the crumb tray.
- C. Unscrew feet and remove base
- D. Loosen the two nuts and slide back element retaining strip.
- E. Note the position of the connecting links and wires, then unscrew nuts which secure them to the broken element, bend back the connecting links, pull out the old element and slide in the new element. Fasten connecting links back to their original position by tightening the nuts.
- F. Slide back element retaining strip and tighten nuts.
- G. Make sure that you have the high wattage elements marked 'CENTRE' or low wattage elements marked "END". Different toasters have different element configurations, if you are unsure please call the dualit helpline on 01263 652 500
- H. Refit base plate, feet and crumb tray.

## SERVICING

### REPLACING PROHEAT ELEMENTS

1

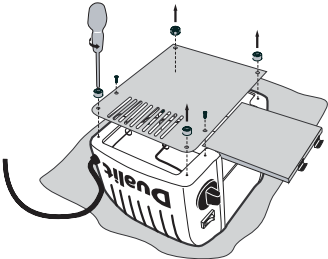

Unplug and place toaster on a soft cloth.  
Remove crumb tray and unscrew feet  
to remove the base plate

2

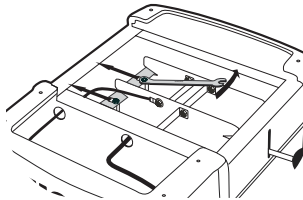

Loosen locking nuts on retaining plate  
using a 6.5mm spanner and slide back

3

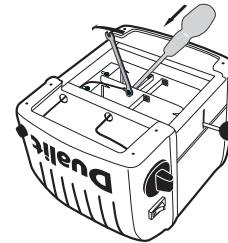

Unscrew brass links and wires.

4

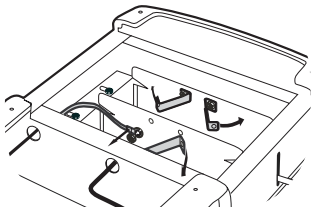

Bend brass links and wires  
away from the element

5

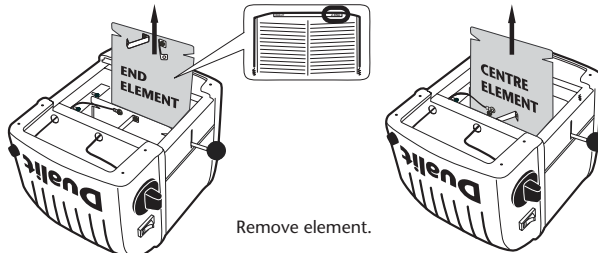

Remove element.

To re-assemble, reverse procedure ensuring wires and parts are correctly positioned.  
Ensure new element is marked the same as the one removed and is seated  
correctly in the channels either side. PAT test before use.

**Dualit**® **CE** 

DUALIT LIMITED COUNTY OAK WAY CRAWLEY WEST SUSSEX RH11 7ST  
TELEPHONE: +44 (0) 1293 652 500 FACSIMILE: +44 (0) 1293 652 555  
EMAIL: [info@dualit.com](mailto:info@dualit.com) WEB: [www.dualit.com](http://www.dualit.com)

02/07