

## SHELVING WITH POLYETHYLENE SHELVES

Tournus Equipement shelving consists of aluminium uprights and polypropylene shelves. Quick and easy to assemble, without tools, by simply snapping into place the parts which stiffens the structure. 12 standard lengths from 608 to 1714 mm, 3 depths (400, 500 and 560 mm) and 2 heights (1750 and 2050 mm). You will always find a length of racking to suit your cold room whether it be line or angle mounted, for a big or small space where low cost sturdy racking is a priority.

**INNOVATIVE SHELF** : overhanging of the shelves to cover the upper part of the aluminium bar, for an optimal fit.

**TOURNUS EXCLUSIVE** : there is a space at the edge of the shelves where white board erasable markers can be used to note the content of the shelf, helps manage the stock of food (erasable markers are supplied with shelving).

**QUICK AND EASY TO ASSEMBLE**: one person alone can assemble 5 metres in 5 minute without tools.

**HYGIENE** : the shelving is classified by the mark NF food hygiene. The shelving is made of food quality materials, smooth surfaces, with no lumps or nooks. No food matter can get trapped and they are machine washable.

**OPTIMUM ACCESSIBILITY** : the corner hook does away with the upright so as to store products in the corner. Floor cleaning is easier.

**STURDINESS** : uprights made of tubular anodised aluminum 32 x 30 mm. The locking assembly and adjustable feet ensure high stability. The load resistance is 200 kg per level for any length of shelves up to 1512 mm.



**NEW  
Solid  
shelves**



## SHELVING WITH SOLID SHELVES

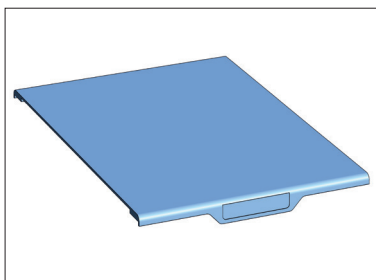

Racking with solid polypropylene shelves, 500 mm deep. Can be assembled in a line and at an angle. Even greater storage options.

The shelves and solid shelves are compatible with other models so racking can be combined in one same set.

## MORE ACCESSORIES



**1 - Stainless steel separation panels** used to store bottles.

**2 - Rear protection bar** ensures protection of the adjoining wall.

**3 - Plate for fixing to the floor and plate for fixing to the wall** are useful in extreme situations (for use on boats).

**MOBILE SHELVING WITH GUIDANCE RAILS**  
optimizes the storage space



## TECHNICAL SPECIFICATIONS

The shelving is made of uprights and shelves.

### UPRIGHT :

- Anodised aluminium structure.
- 2 heights : 1750 and 2050 mm.
- Pre-mounted studs to fix shelves.
- Tubular tube 32 x 30 mm.
- Adjustable legs with no apparent thread.

### SHELVES :

- Tubular side members 25 x 42 mm.
- Shelves made of polypropylene or aluminium
- Tapered self-locking insertion assembly without tools.
- Shelves are placed on the bars
- 3 depths : 400, 500 and GN (560 mm).
- 12 base lengths : 608 to 1714 mm.
- Temperature resistance : - 30°C to + 60°C in use (shelves can be machine washed at 90°C).
- Load up to 200 kg by level.

