



7950.0042

Onderdelen informatie

Erzatzteil information

Spare part information

Information de pièces



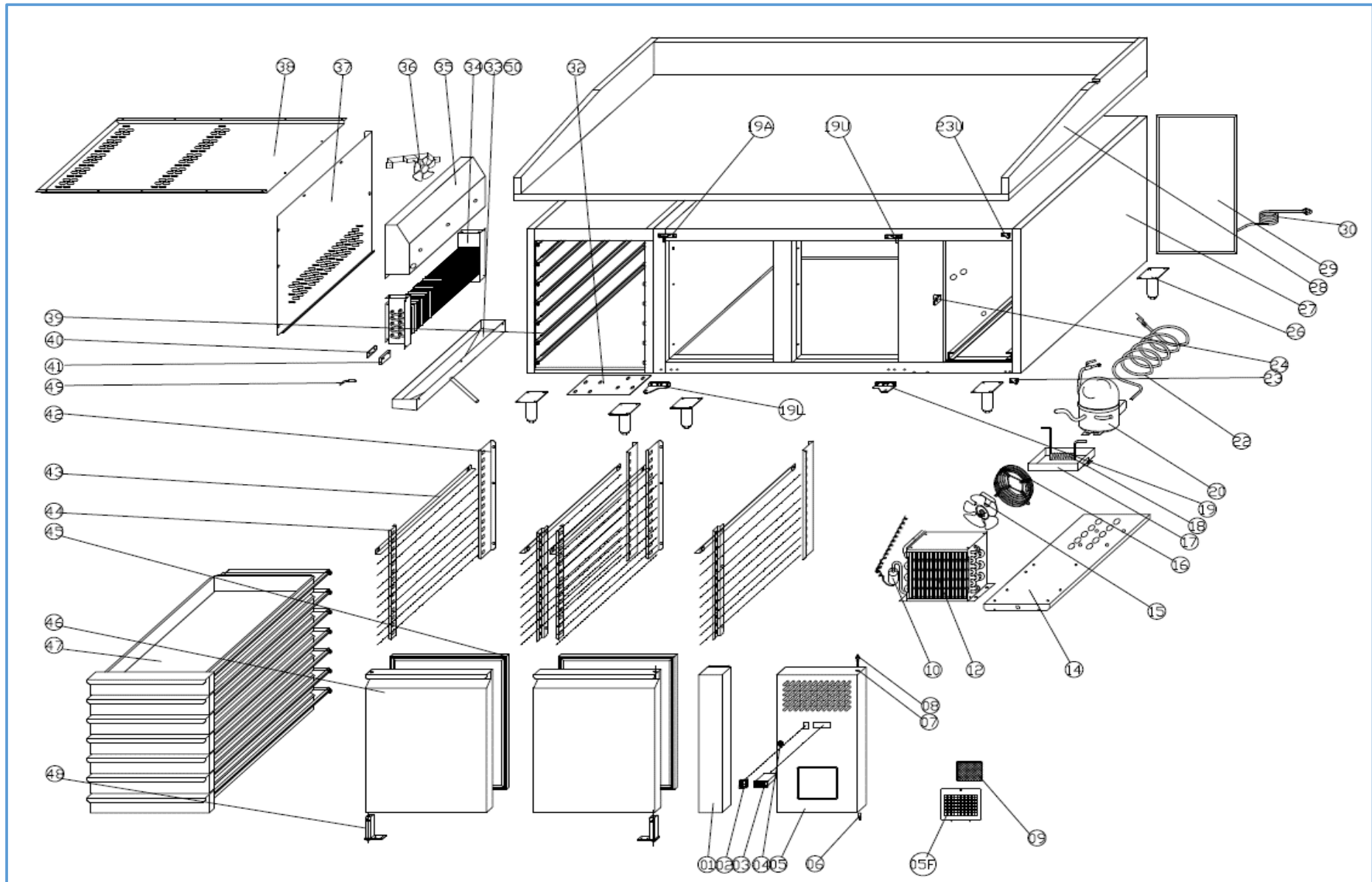

Onderdelenlijst 7950.0042

POS:	Art.No.:	Omschrijving:			Aantal:
1		FIXED FRONT PANEL	STAINLESS		1PC
2	9108.0244	MAIN SWITCH			1PC
3	9338.3545	THERMOSTAT			1PC
4	9338.0300	LOCK			1PC
5	9338.0025	FRONT PANEL	STAINLESS		1PC
5F		AIR FLOW WINDOW			1PC
6	9338.0670	HINGE AXIS	STAINLESS		2PCS
7	9338.0295	BUSHING	PLASTIC		4PCS
8	9338.0105	NUT	STAINLESS		2PCS
9		FILTER			1PC
10	9338.1980	FILTER DRIER	XH-9		1PC
12	9338.0780	CONDENSER			1PC
14		UNIT BOARD	ZINC		1PC
15		CODENSER FAN			1PC
16		BASKETC GUARD GRILLS	COATED STEEL		1PC
17	9338.2176	WATER BOX	STAINLESS		1PC
18		EVAPORATE PIPE	COPPER		1PC
19		DOOR HINGE RIGHT	STAINLESS		1PC
19U		DOOR UP HINGE RIGHT	STAINLESS	RIGHT	1PC
19L	9338.1300	DOOR HINGE LEFT	STAINLESS		1PC
19A		DOOR UP HINGE LEFT	STAINLESS	LEFT	1PC
20	9338.1662	COMPRESSOR			1PC
22		SUCTION PIPE+CAPILLARY	COPPER		1PC
23		FRONT PANEL HINGE	STAINLESS		1PC
23U		FRONT PANEL UP HINGE	STAINLESS		1PC
24		LOCK HOOK	STAINLESS		1 PCS
26	4627.052	FEET			8PCS
27		BODY			1PC
28		TOP	MARBLE		1PC
29		UNIT ROOM COVER	ZINC		1PC
30	9338.2208	PLUG			1PC
32		CONNECTION BOARD FRONT	ZINC		1PC
.		CONNECTION BOARD BACK			1PC
33	9338.0256	EVAPORATOR WATER PAN	STAINLESS		1PC
34	9338.0255	EVAPORATOR			1PC
35		FAN SUPPORT			1PC
36	9338.0130	CIRCUIT FAN			1PC
37		EVAPORATOR COVER	STAINLESS		1PC
38		AIR FLOW CONDUCT BOARD	STAINLESS		1PC
39		DRAWER GUIDE	STAINLESS	LEFT	7PAIRS
40		PROBE PADDING	STAINLESS		1PC
41	9338.1502	SENSOR FIXED CLIP			1PC
42		BACK SUPPORT	STAINLESS	LEFT	2PCS
43	4627.014	GUIDE	STAINLESS	LEFT/RIGHT	14PAIRS
44		FRONT SUPPORT	STAINLESS	LEFT/RIGHT	4PCS
45	9338.1627	GASKET	PLASTIC		2PCS
46	9338.0285	DOOR		LEFT/RIGHT	2PCS

Onderdelenlijst 7950.0042

POS:	Art.No.:	Omschrijving:			Aantal:
47		DRAWER			7PCS
48	9635.0150	DOOR SPRING HINGE			2PCS
49	9181.2050	SENSOR			1PC